

MECHANICAL DIRECTIONAL CONTROL VALVE (HD1) SIZE 02



■ Features

This type of valve switches the direction of flow of hydraulic fluid by pushing down the cam plunger.

⚠ Cautions on use Please read the Operating Manual carefully to ensure correct usage.

- The edge angle of the dog (cam) should be 30-deg. or less.

■ Description of the model designation

HD1-42MT-BcA-02A

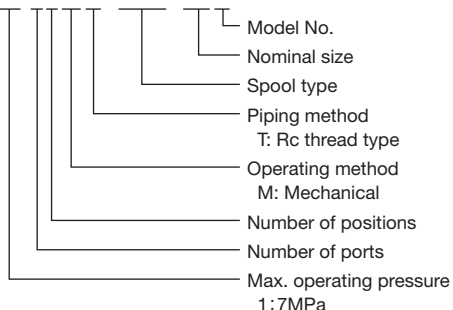

■ Specifications

Nominal Size	Rated Flow (L/min)	Max. Operating Pressure (MPa)	Cam pressing-down force (N)	Permissible Back Pressure (MPa)	Model
02	6	7	120	0.2	HD1-42MT-BcA-02A
					HD1-32MT-1-02A
					HD1-32MT-2-02A

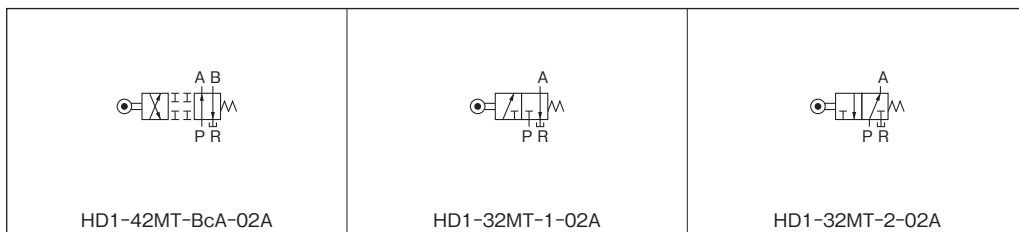

■ Outside dimensions

HD1-42MT-BcA-02A

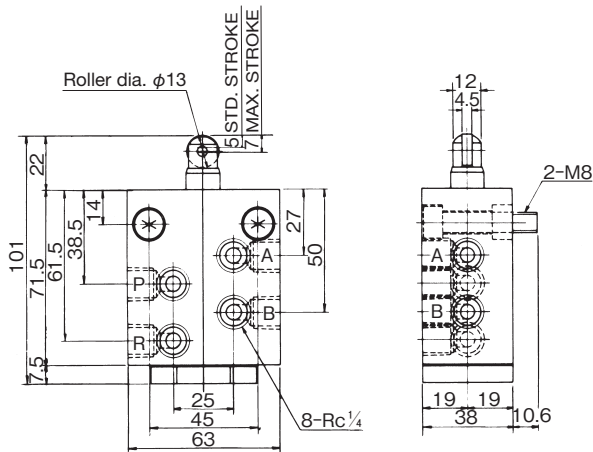

HD1-32MT-*02A

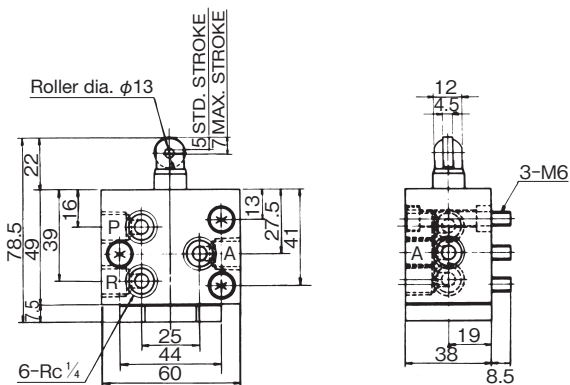

MASS: HD1-42MT-BcA-02A: 1.2 kg
HD1-32MT-*02A: 0.8 kg

MECHANICAL DIRECTIONAL CONTROL VALVE (HD3) SIZE 03



Features

This type of valve switches the direction of flow of hydraulic fluid by pushing down the cam plunger. Operation of the cam plunger, instead of a spool movement driven by the solenoid, switches the direction of flow.

⚠ Cautions on use Please read the Operating Manual carefully to ensure correct usage.

- If valves other than those indicated below are required, please consult us.
- If subplate SHD03-**T*(A) is necessary, please order one separately.
- The edge angle of the dog (cam) should be 30-deg. or less.
- Finish the mounting faces to the same quality as the valve faces (3.2 μmRz).

Description of the model designation

HD3-42MG-BcA-03A

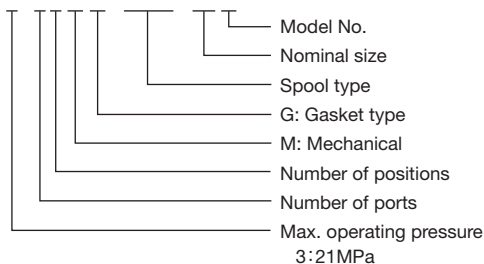

Specifications

Nominal Size	Rated Flow (L/min)	Max. Flow (L/min)	Max. Operating Pressure (MPa)	Cam pressing-down force (N)	Permissible Back Pressure (MPa)	Model
03	40	50	21	180	3	HD3-42MG- -03A

For , refer to table below.

 BcA	 BgA	 KcP
 BdA	 Bd1A	

Outside dimensions

HD3-42MG-*-03A**

● For the sub-plate SHD03-**T1A, refer to page L-2.
SHD03-**T3A, refer to page L-6.

Mass: 3.0kg