

Features

1. Five mount types can be configured by assembling the relevant accessories on the base model.
 2. The cylinder is highly wear resistant since the cylinder tube internal face is finished by precision honing and the piston rod is coated by hard chromium plating.
 3. The sliding section of the piston rod adopts a PS seal that features high durability.
- The cushion and air bleeder cannot be installed.

Description of the model designation

T-HC1-20×50- (FA) - (A)

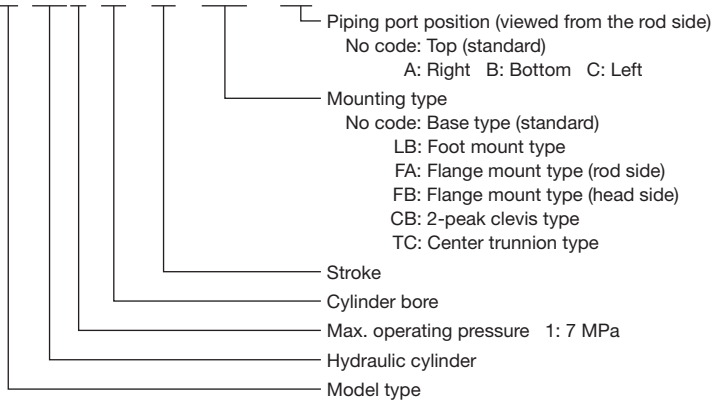

Specifications

Max. operating pressure		7 MPa
Min. working pressure	Head side	0.3 MPa
	Rod side	0.4 MPa
Operating speed range		8 to 150 mm/s
Operating temperature range		0 to 60 °C

Standard stroke

Model	Max. available stroke (mm)
T-HC1-20	600
T-HC1-25	600
T-HC1-30	600

NOTE: A cylinder with a stroke of more than 600 mm cannot be manufactured.

Permissible stroke error

Stroke	100 or less	100 to 250	250 to 500
Permissible error	+0.8 0	+1.0 0	+1.25 0

■ Outside dimensions

Standard

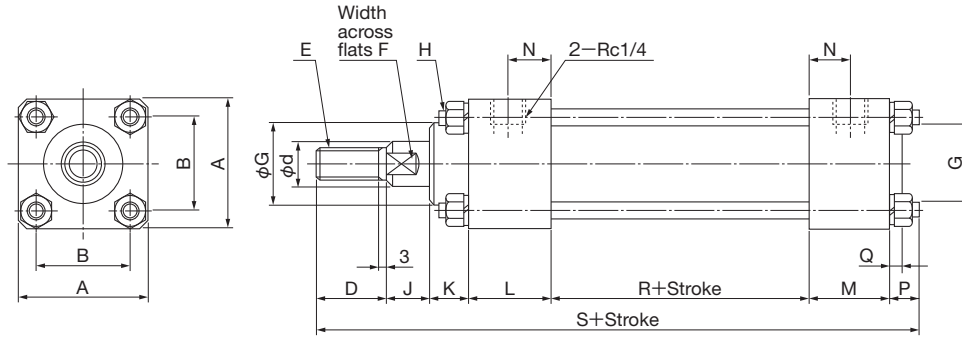

Model	Symbol (Unit: mm)																	
	A	B	D	E	F	$\frac{d}{(r8)}$	$\frac{G}{(r9)}$	H	J	K	L	M	N	P	Q	R	S	
T-HC1-20x*	45	33	20	M 8x1.0	8	10	28	M6	15	13	28	28	14	9	3	45	158	
T-HC1-25x*	45	33	20	M 8x1.0	8	10	28	M6	15	13	28	28	14	9	3	45	158	
T-HC1-30x*	45	33	25	M12x1.25	13	15	28	M6	15	13	28	28	14	9	3	45	163	

LB (Foot mount type)

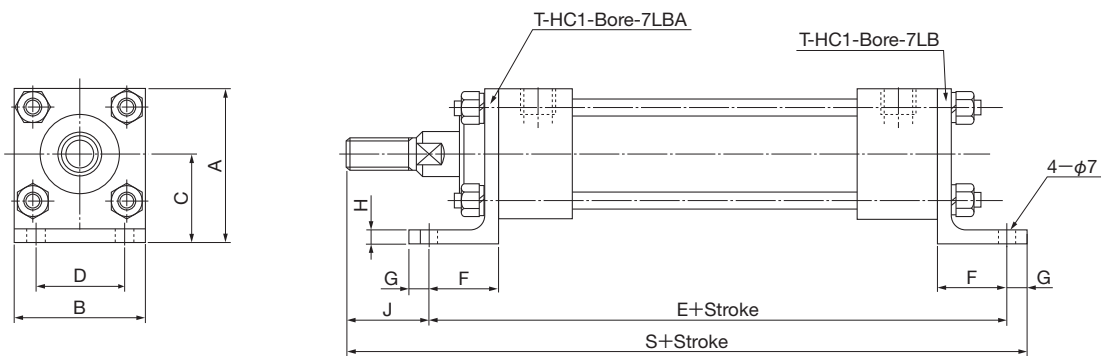

Model	Symbol (Unit: mm)									
	A	B	C	D	E	F	G	H	J	S
T-HC1-20x*-LB	54.5	45	32	30	151	25	7	5	23	181
T-HC1-25x*-LB	54.5	45	32	30	151	25	7	5	23	181
T-HC1-30x*-LB	54.5	45	32	30	151	25	7	5	23	186

FA (Rod side flange mount type)

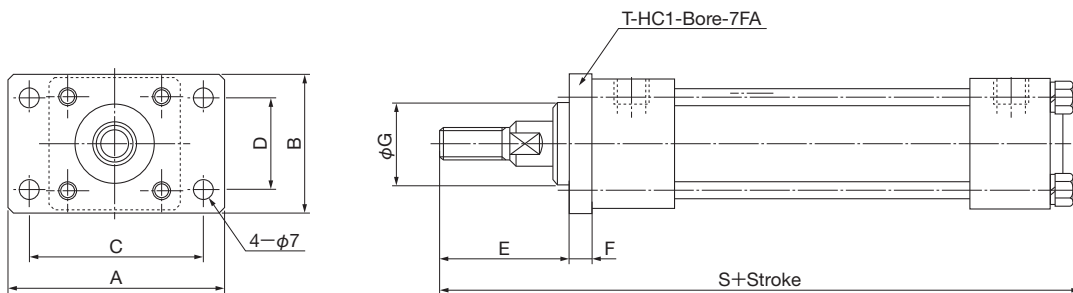

Model	Symbol (Unit: mm)							
	A	B	C	D	E	F	$\frac{G}{(r9)}$	S
T-HC1-20x*-FA	75	46	62	30	40	8	28	158
T-HC1-25x*-FA	75	46	62	30	40	8	28	158
T-HC1-30x*-FA	75	46	62	30	45	8	28	163

■ Outside dimensions

FB (Head side flange mount type)

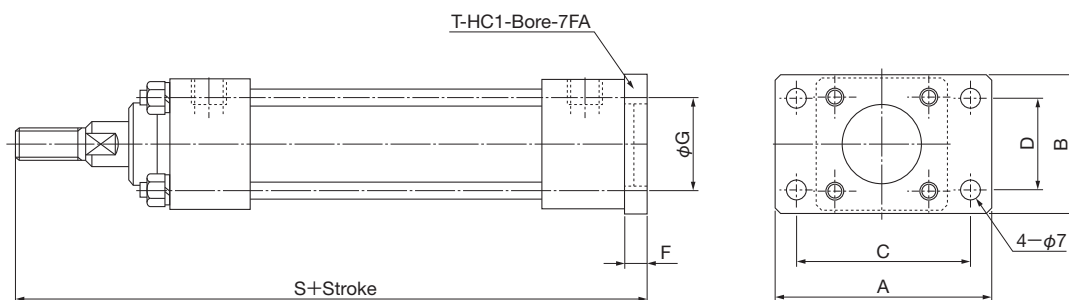

Model	Symbol (Unit: mm)						
	A	B	C	D	F	$\frac{G}{(E\theta)}$	S
T-HC1-20x*-FB	75	46	62	30	8	28	157
T-HC1-25x*-FB	75	46	62	30	8	28	157
T-HC1-30x*-FB	75	46	62	30	8	28	162

CB (2-peak clevis type)

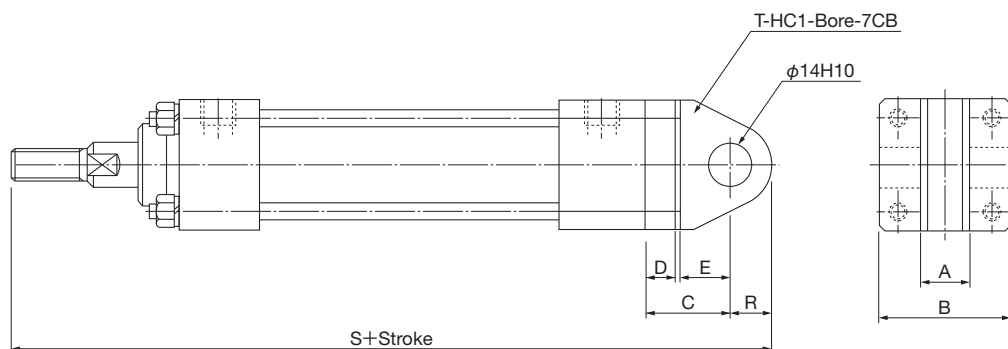

Model	Symbol (Unit: mm)						
	A	B	C	D	E	R	S
T-HC1-20x*-CB	16	45	28	10	16	14	191
T-HC1-25x*-CB	16	45	28	10	16	14	191
T-HC1-30x*-CB	16	45	28	10	16	14	196

TC (Center trunnion type)

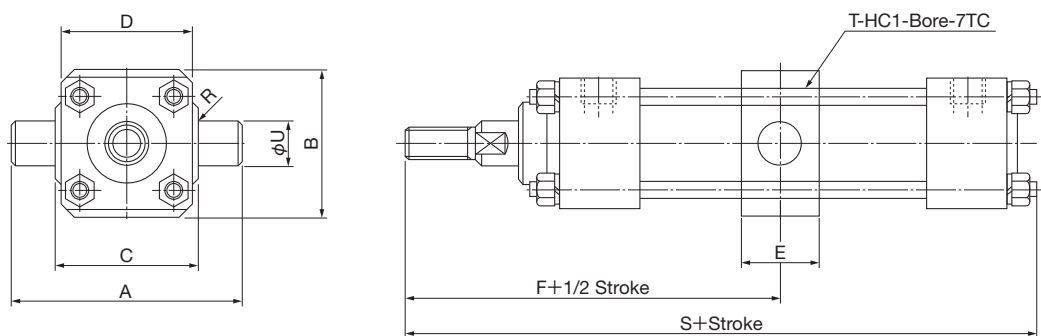

Model	Symbol (Unit: mm)								
	A	B	C	D	E	F	$\frac{U}{(e\theta)}$	R	S
T-HC1-20x*-TC	80	50	50	40	26	98.5	15	1	158
T-HC1-25x*-TC	80	50	50	40	26	98.5	15	2	158
T-HC1-30x*-TC	80	50	50	40	26	103.5	15	2	163